

LEGEND

- APPROXIMATE PROPOSED FACILITY BOUNDARY
- PROPOSED EXPANSION WASTE AREA
- EXISTING PERMITTED LIMIT OF WASTE AREAS
- TREES / VEGETATION
- EXISTING FENCE
- PROPOSED FENCE
- ACCESS ROAD (SEE NOTE 1 FOR EXISTING VS. PROPOSED)
- PERIMETER STORMWATER DITCH (SEE NOTE 1 FOR EXISTING VS. PROPOSED)
- CULVERT (SEE NOTE 1 FOR EXISTING VS. PROPOSED)
- PROPOSED CONTOUR: BOTTOM OF RECOMPACTED SOIL LINER (FEET MSL)
- CONSTRUCTED EXCAVATION/EXISTING CONTOUR EXCEPT AS NOTED IN NOTE 1

NOTES

- EXISTING CONTOURS DEVELOPED FROM SITE AERIAL TOPOGRAPHIC SURVEY BY MARTINEZ CORPORATION ON APRIL 16, 2007, UNLESS OTHERWISE NOTED BELOW.  
CELL 8 AREA: FINAL PERMITTED COVER DESIGN  
DETENTION BASIN 5R: PROPOSED CONTOURS  
DETENTION BASINS 3 AND 6: PERMITTED CONTOURS  
CELLS 1-6: CONSTRUCTED EXCAVATION GRADE CONTOURS  
CELL 7: PERMITTED CONTOURS  
PERIMETER AREAS NORTH, EAST, AND SOUTH OF CELLS 7, 9, AND 10: PROPOSED CONTOURS
- FOR CLARITY, NOT ALL SITE FEATURES MAY BE SHOWN.
- THE NEED FOR FLEXIBILITY TO ACCOMMODATE ADJUSTMENTS AND MODIFICATIONS IS ANTICIPATED CONSIDERING THE SIZE, COMPLEXITY, AND LIFE OF THE PROJECT.
- PERIMETER STORMWATER CONTROL WILL BE CONSTRUCTED AS FILLING PROGRESSES TO PREVENT RUN-ON ONTO THE LANDFILL.
- CELLS 1-6 AND 8 HAVE BEEN CONSTRUCTED. REMAINING CELL DEVELOPMENT WILL PROCEED IN THE ORDER OF CELL 7, CELL 9, AND CELL 10.
- THE PROPOSED CONTOURS ON THIS DRAWING WITHIN THE PROPOSED EXPANSION WASTE AREA REPRESENT THE APPROXIMATE EXCAVATION GRADES (BOTTOM OF LINER) FOR THE LANDFILL. HALF-TONED CONTOURS SHOWN WITHIN THE PROPOSED EXPANSION WASTE AREA REPRESENT THE AS-BUILT EXCAVATION GRADES OF PREVIOUSLY CONSTRUCTED AND/OR PERMITTED CELLS.
- EXCAVATION GRADING MAY BE REVISED TO ACCOMMODATE ANY CONDITIONS OR DESIGN CHANGES REQUIRED BY THE ILLINOIS ENVIRONMENTAL PROTECTION AGENCY.

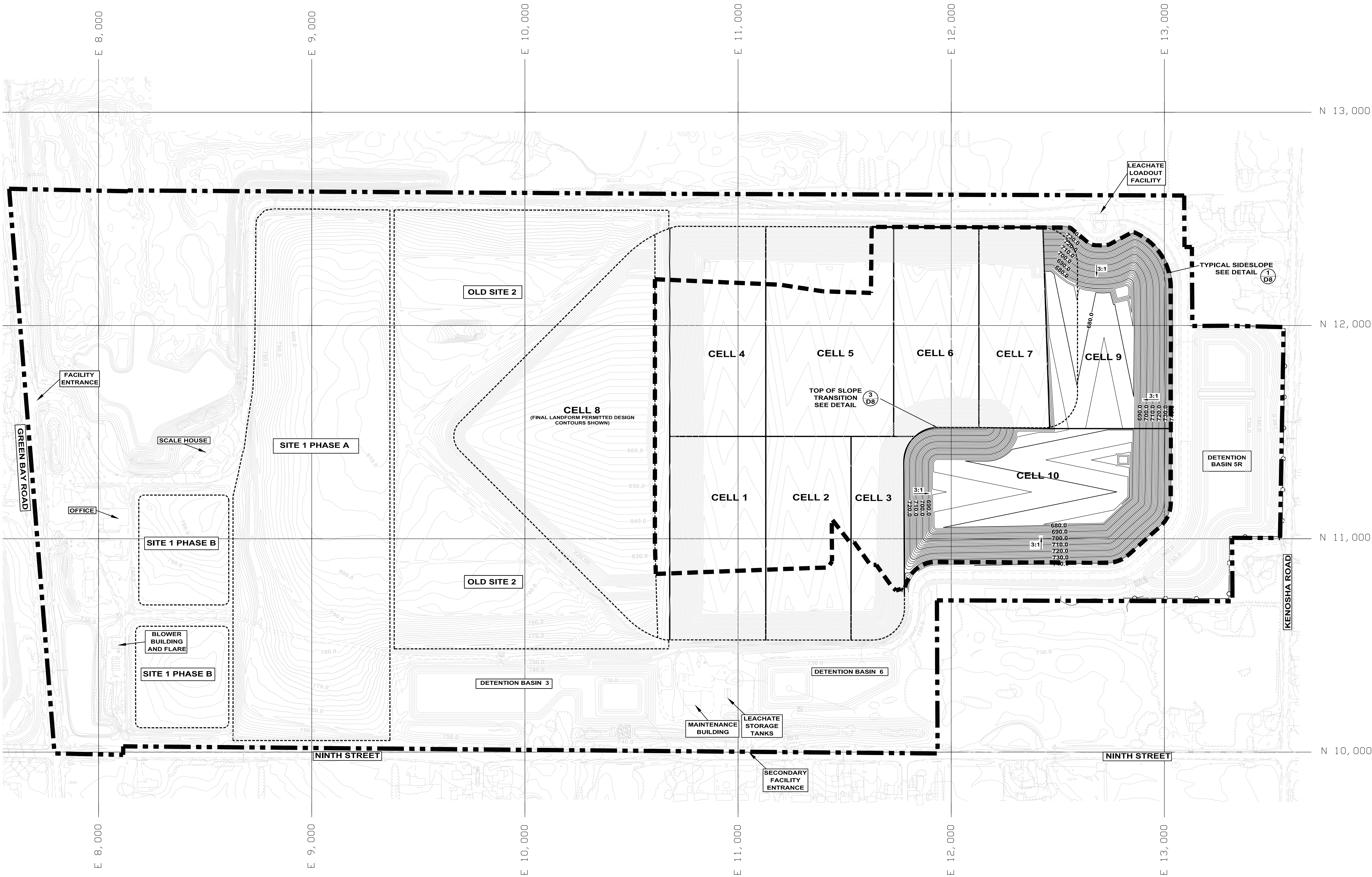

REV. NO.	DATE	DESCRIPTION



VEOLIA E.S. ZION LANDFILL-SITE 2 EAST EXPANSION  
CITY OF ZION, ILLINOIS

EXCAVATION GRADES

PROJ. NO.:	122150	DATE:	FEBRUARY 2010
DESIGNED BY:	RDS	DRAWING NO.	D4
DRAWN BY:	BWM		
CHECKED BY:	RDS		
APPROVED BY:	DAM		

T:\AutoCAD\Projects\122150\Drawings\122150-D04.dwg 1/18/2010 2:39:23 PM CST